



Soluții pentru publicitate și decor

DIAMONDBACK LED MODULES



RoHS



LM-80

Features

- Powered by high output 2835 LED.
- Constant current.
- Clear 170° optic lens.
- 50 pcs per string.
- CE, RoHS, UL, TUV, BIS, CB and LM-80 certified.

Application

- Apply to 6–15 cm depth illuminate letter or light box at airports, metros, banks, buildings and shopping malls, etc.

Parameters

Items	Parameters	
Part Number	ZE02QBE / ZE02QD1	ZE03QBE / ZE03QD1
CCT (K)	7000K / Red / Green / Blue	7000K / Red / Green / Blue
Beaming Angle (°)	170°	170°
CRI (Ra)	≥ 80	≥ 80
Luminous Flux (lm)	90	140
Voltage (V)	DC12/24	DC12/24
Power (W)	0.8	1.2
Driving Method	Constant Current	Constant Current
Dimension (mm)	66*18*7.3	88*18*7.3
Working Tem. (°C)	-25 ~ +60	-25 ~ +60
Storage Tem. (°C)	-25 ~ +70	-25 ~ +70
Protection Grade	IP65	IP65

Dimension

Unit: mm

ZE02QBE / ZE02QD1

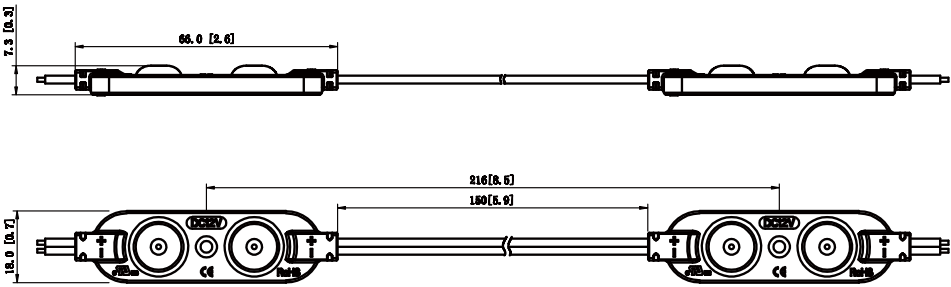

ZE03QBE / ZE03QD1

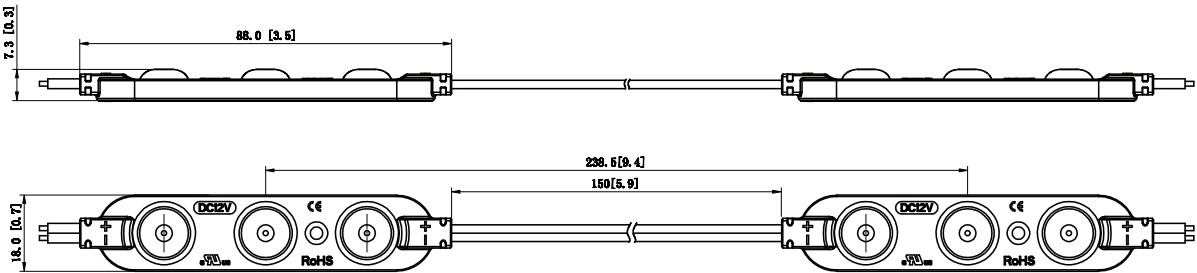

Beaming Angle

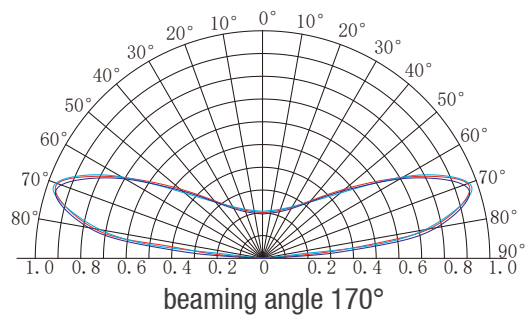

Reference Scheme

Part Number	Depth(mm)	Distance(mm)	Illumination(lux)
ZE02QBE / ZE02QD1	60	Dx=80 Dy=80	5100
	80	Dx=100 Dy=100	4600
	120	Dx=120 Dy=120	2600
	120	Dx=140 Dy=140	1200
	140	Dx=160 Dy=160	900

Part Number	Depth(mm)	Distance(mm)	Illumination(lux)
ZE03QBE / ZE03QD1	60	Dx=100 Dy=100	5000
	80	Dx=120 Dy=120	4700
	120	Dx=140 Dy=140	3300
	120	Dx=160 Dy=160	2200
	140	Dx=180 Dy=180	1300

Remark :

- 01. The transmittance of the Acrylic was 44%.
- 02. The above data is for reference only.

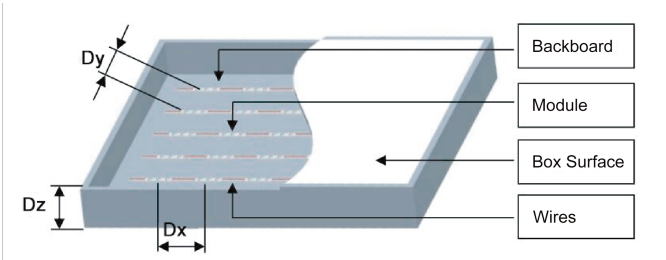

Wire Connection

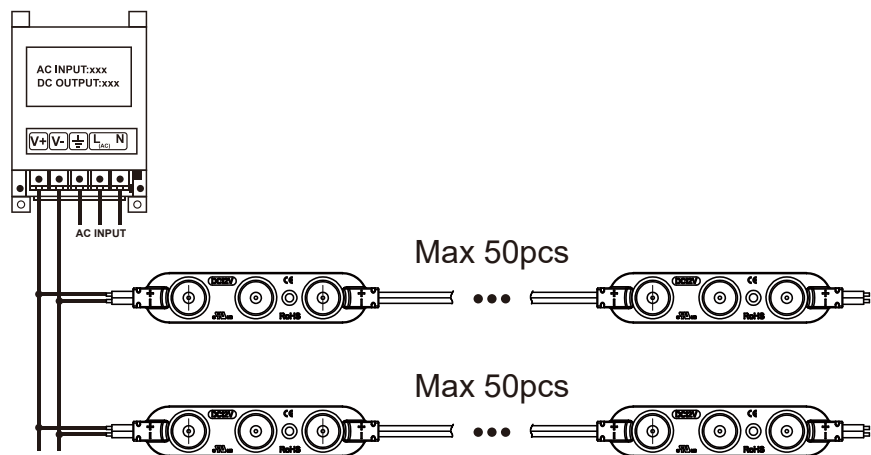

Declaration

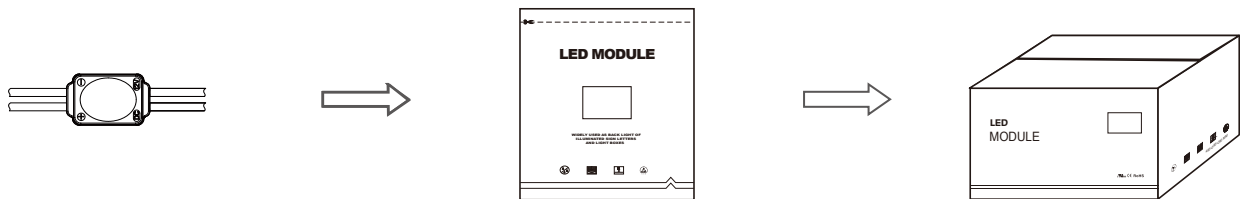

ZE02QBE / ZE02QD1 50 pcs per string
ZE03QBE / ZE03QD1 50 pcs per string

150 pcs in an antistatic bag
100 pcs in an antistatic bag

1350 pcs per carton
1000 pcs per carton

Packing Specification

- Antistatic bag adopted
- Packing information

Part Number	ZE02QBE / ZE02QD1	ZE03QBE / ZE03QD1
Carton dimension(mm)	490*450*220	490*450*220
Bags per carton	9	10
Quantity per carton(pcs)	1350	1000
Net Weight(kg)	14(1±10%)	16(1±10%)
Gross Weight(kg)	16(1±10%)	18(1±10%)

Due to the packing manner difference, please adhere to the original products in case of discrepancy found between the picture and actual product.

Self-provided tools & material

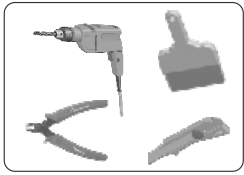

Dust brush, cutter, pencil, wire stripper, and drill

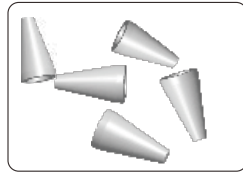

Wire Connector (Standard)

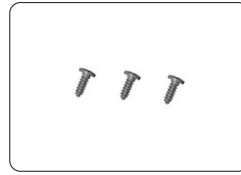

Screw

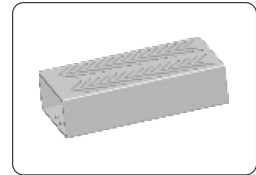

Power Supply

Installation Guidance

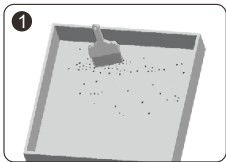

- Clean inside the light box.

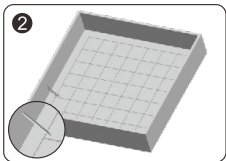

- Determine the appropriate layout.

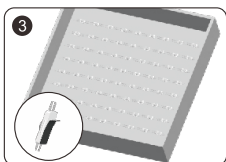

- Peel tape backing and stick modules into place.

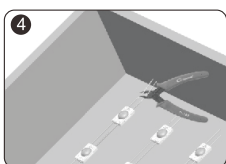

- Remove the unneeded modules.
- ⚠ Note: Cut in the middle position of the wires between modules.

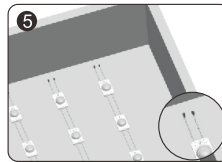

- Strip the end wire for 10mm and cap with the wire connector. Waterproof and anti-corrosion must be done on the connectors.

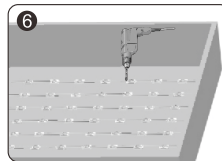

- Locate modules in the optimal position and secure with screws or neutral glass cement, which should be applied at the edge of the modules.

⚠ Note: Avoid breaking the module and wire when fixing with a drill.

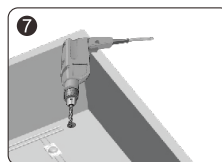

- Drill a hole for connecting power cable. Fixation and protection for the cable must be done on the hole.

⚠ Note: Avoid breaking the light box in drilling the hole.

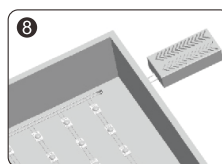

- Connect to the power cable and make sure that the polarity for connection is correct.

⚠ Note: Red wire is positive and black wire is negative.

Instructions

01. Disassembling or modifying the product is not allowed.
02. Installation with power on is not allowed.
03. Any organic solvent chemical is not allowed.
04. Acidic or alkaline adhesive is not allowed when install, neutral glass cement could be used for installation purpose, make it drying in open environment for four hours.
05. Isolation and corrosion prevention on all wiring points and wire ends.
06. Make sure the power wire is thick enough and ensure the voltage and connections are connected correctly before power on.
07. This product should be used inside the signage, do not expose it in opening site.
08. Installation, maintaining should be done by professional staff.
09. The maximum connection in a series is 50pcs, please do not exceed this number.
10. The power wire between power supply and module should be less than two meters to keep the same brightness on all parts.
11. Initial location with 3M tape, then secure with screws.

Declaration

01. Warranty: 5 years.
02. In order to ensure the safety, the broken wires need to be replaced by the manufacturer or the service agent, or by the staff with the similar qualification.
03. The given data in the specification was based on the laboratory testing, there may be discrepancy found in the actual products.
04. The given drawings in the specification are only for reference, there may be discrepancy found in the actual products.
05. The products are subject to change without prior notification.

BUCUREȘTI:

bucuresti@verla.ro

Tel: +4 0729 016 484

CLUJ-NAPOCA

cluj@verla.ro

Tel: +4 0721 242 216

IAȘI

iasi@verla.ro

Tel: +4 0745 381 525